



BLADE

PET FELT BAFFLES

BLADE

PET FELT BAFFLES

Slice through the noise with Blade PET felt baffles. These beautifully constructed PET felt baffles feature an extrusion mounted to the top edge to accommodate various installation conditions and achieve a sleek look with minimal effort, and maximum acoustic performance.

- Pre-Engineered systems available for customized sizes and quick delivery
- Top mounted extrusion keeps baffles straight and aligned
- Available in a wide variety of colors and wood grain prints
- 60% Post-Consumer Recycled Content

SPECS

Material Composition: 60% Post-Consumer Recycled PET Felt

Blade Thickness: 1/2", 1", 2"

Blade Height: 4" to 48"

Blade Length: 2' to 10'

Installation Method: Threaded Rod, Hanging Wire, T-Grid, Unistrut, Direct Attach

Fire Rating: Class A Fire Rated per ASTM E84

VOC Emissions: Passes CDPH Standard v1.2

Acoustic Performance: Average Sabins / Baffle - 1/2" – 6.1; 1" – 8.1; 2" – 10.3



DETAILS

BLADE

BLADE can be customized in height, and length to achieve the perfect size for your space. BLADE can be easily assembled with an extrusion that can accomodate typical installation methods.

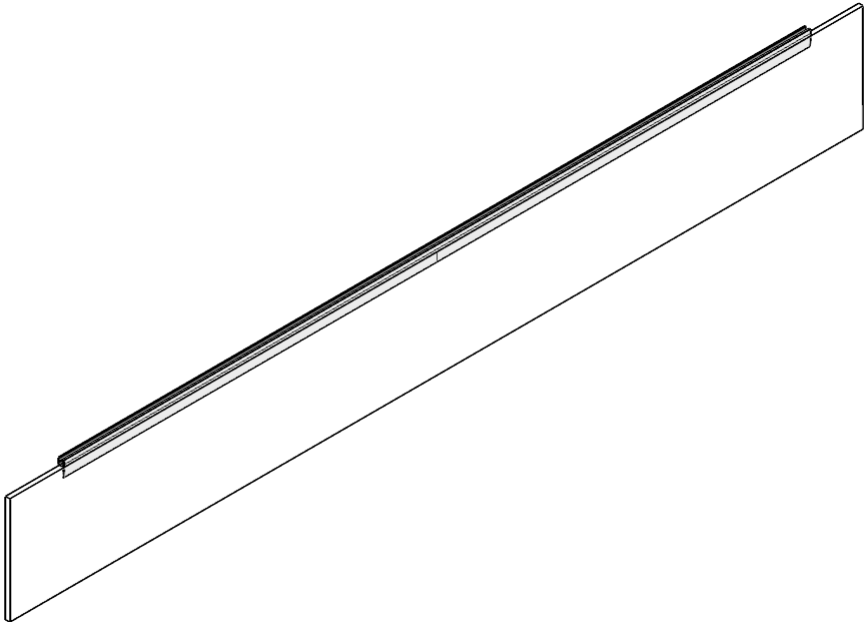

TOP VIEW - 1/2" BLADE

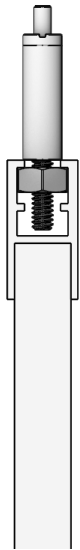

CABLE ATTACHMENT
- 1/2" BLADE

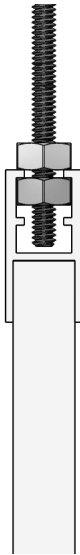

THREADED ROD
ATTACHMENT - 1/2"
BLADE

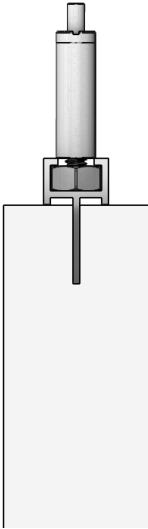

CABLE ATTACHMENT
- 1" AND 2" BLADE

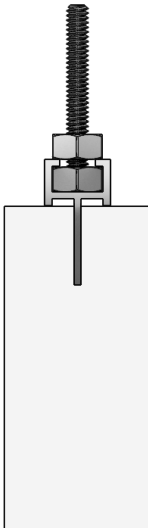

THREADED ROD
ATTACHMENT - 1"
AND 2" BLADE



COLORS

Decorative and tackable, available in a variety of colors or printed with wood grain or custom graphics to blend into any decor.

Class A Fire Rated Colors



Non-Fire Rated Colors



Printed Wood Grain

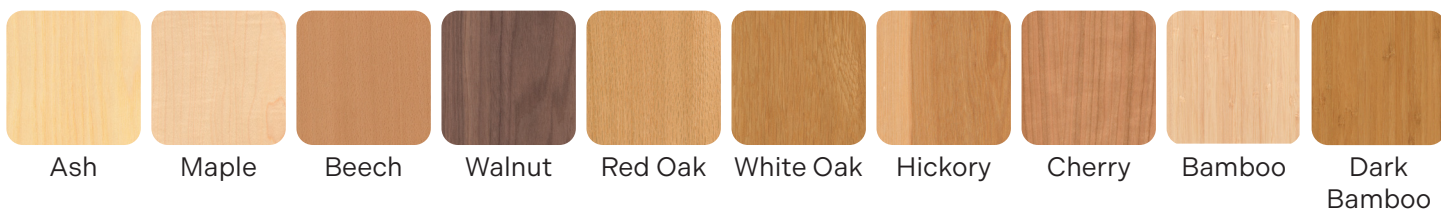

PERFORMANCE

Material Logiq PET Felt is non-allergenic, non-toxic, fungal-resistant, and does not contain chemical irritants or formaldehyde. Acoustic panel material: 100% polyester (60% PET-recycled fiber, 40% PET-virgin fiber). Our PET Felt passes the CDPH V1.2 test standard for low VOC emissions and can contribute to LEED V4.1 EQ Credit: Low-Emitting Materials.

