

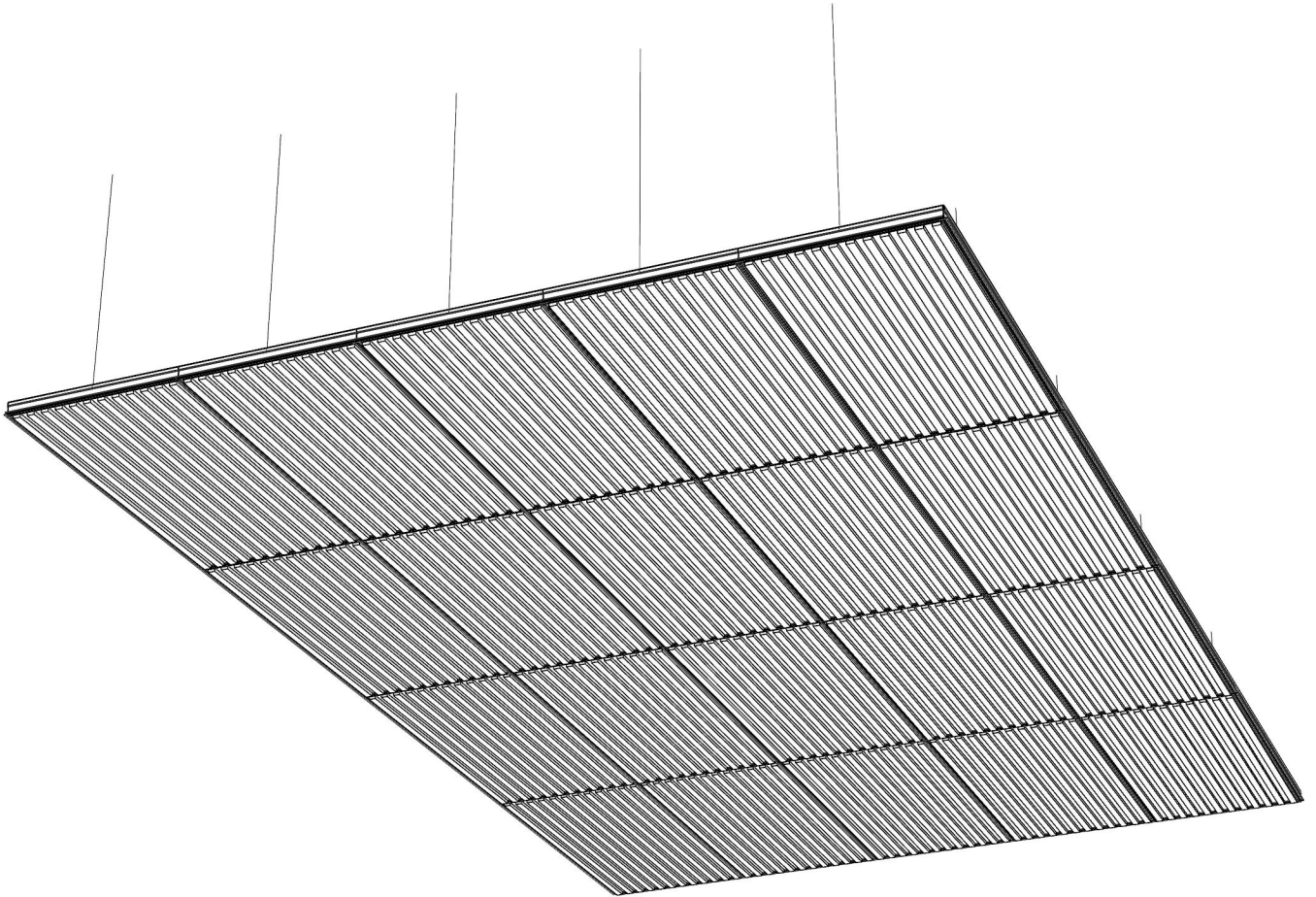

MATERIAL LOGIQ



INSTALLATION INSTRUCTIONS: **SLATTA TILE**

INSTALLATION METHOD: **CEILING GRID**

Overview// Parts and Hardware

ATTENTION: If you have additional questions after review of this manual please contact your local Material Logiq representative or a Material Logiq professional at our headquarters (952)448-5300

MATERIAL LOGIQ MANUFACTURES PRODUCTS THAT MUST BE HANDLED WITH CARE. PRODUCTS SHOULD ONLY BE INSTALLED BY EXPERIENCED INSTALLERS.

RECEIVING

Prior to unpacking, check package for any obvious shipping damage. If no evidence of damage is present, move package to a dry/controlled area and inspect it for dents, breakage, or any lesser-noticeable damage that may affect enclosed panels. If damage has been identified, record it/photograph it, and open to inspect for concealed damage. If damage was transferred to the product, document/photograph the issues.

INSTALLATION

Good tools are needed to install panels if cutting is necessary. Care needs to be taken when cutting and fitting around penetrations. To achieve this, the following tools are recommended:

- Table saw (call for blade details)
- Drywall square

SPECIAL HANDLING INSTRUCTIONS

When handling product, care must be taken to not damage face of the panel. Handle all edges with care. To avoid damage, do not twist or bow the panels during installation.

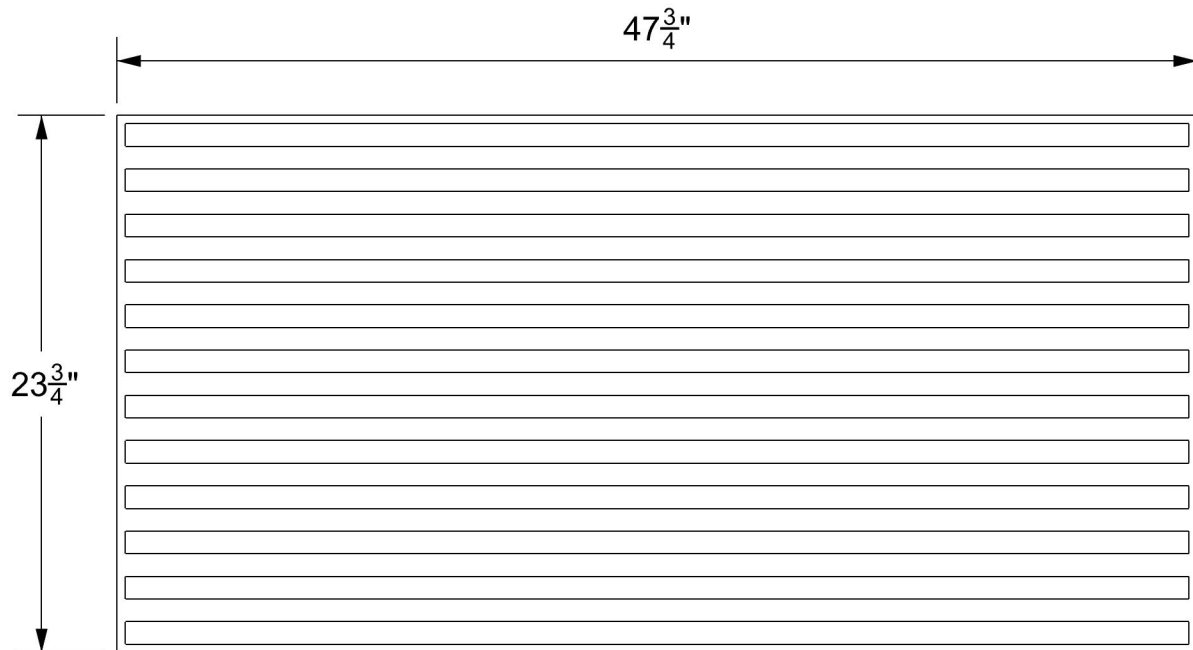

SLATTA TILE

Suspension Specification & Layout

INSTALL T-GRID, WITH MAINS 24" O.C. AND CROSS TEES SPACED AS NEEDED FOR SPECIFIED PANEL.

24" O.C. SPACING MAY NEED TO BE ADJUSTED TO ACCOMADATE CERTAIN CONFIGURATIONS. VERIFY GRID LAYOUT AGAINST SUPPLEMENTAL DOCUMENTATION (IF APPLICABLE) BEFORE INSTALLING

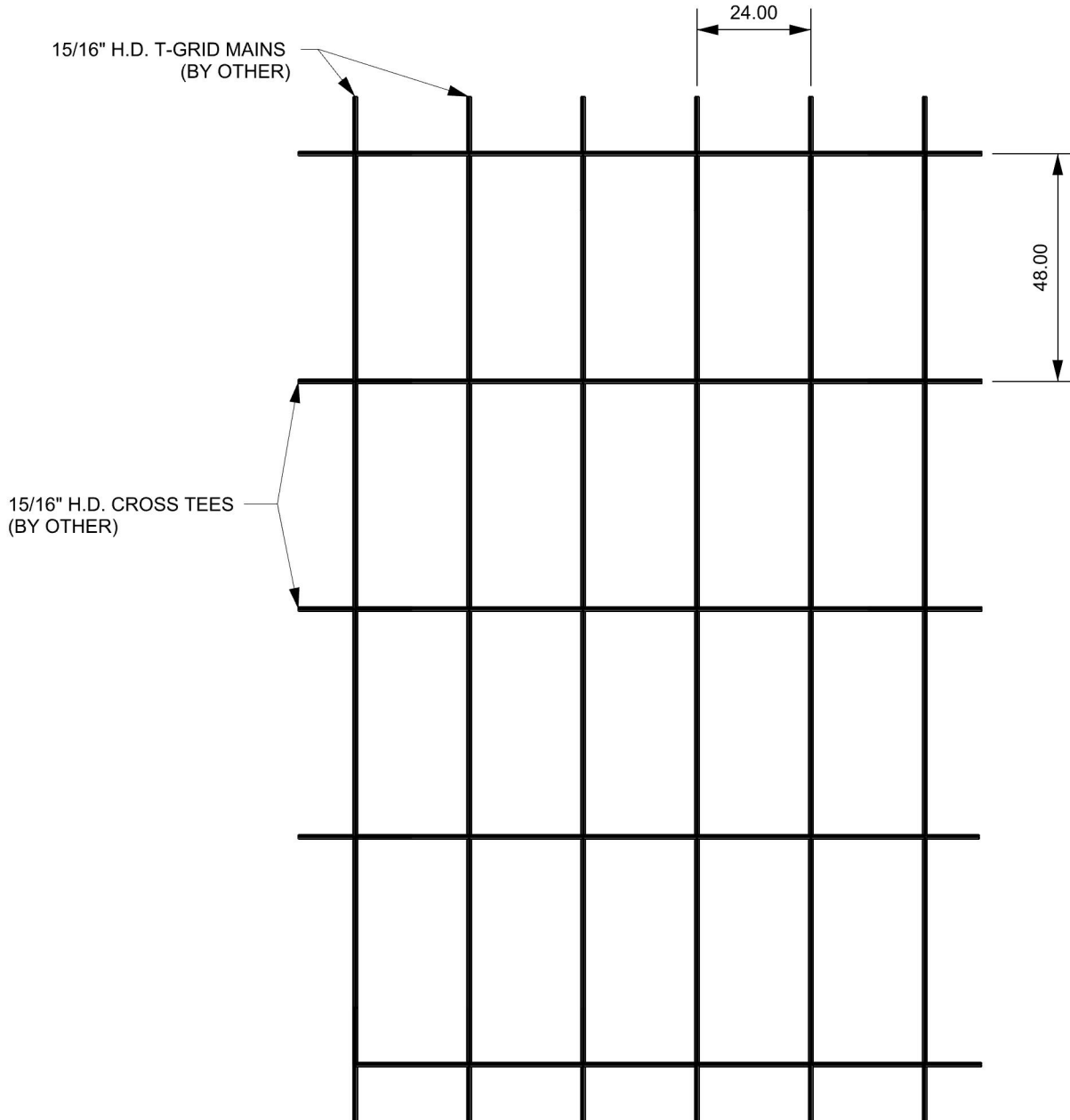

Tile Installation

INSTALL SLATTA TILE INTO GRID ENSURING PROPER ORIENTATION.

VERIFY TILE IS SEATED PROPERLY, WITH BACKER RESTING ON THE GRID AND SLATS PASSING THROUGH THE GRID OPENING

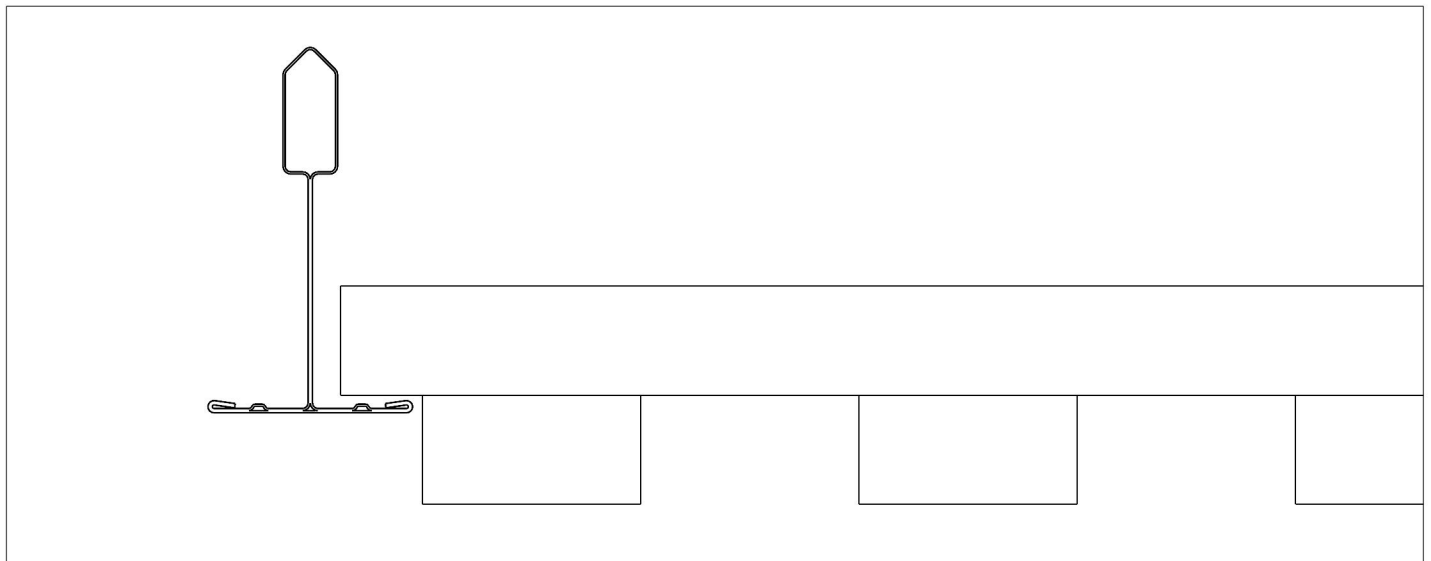
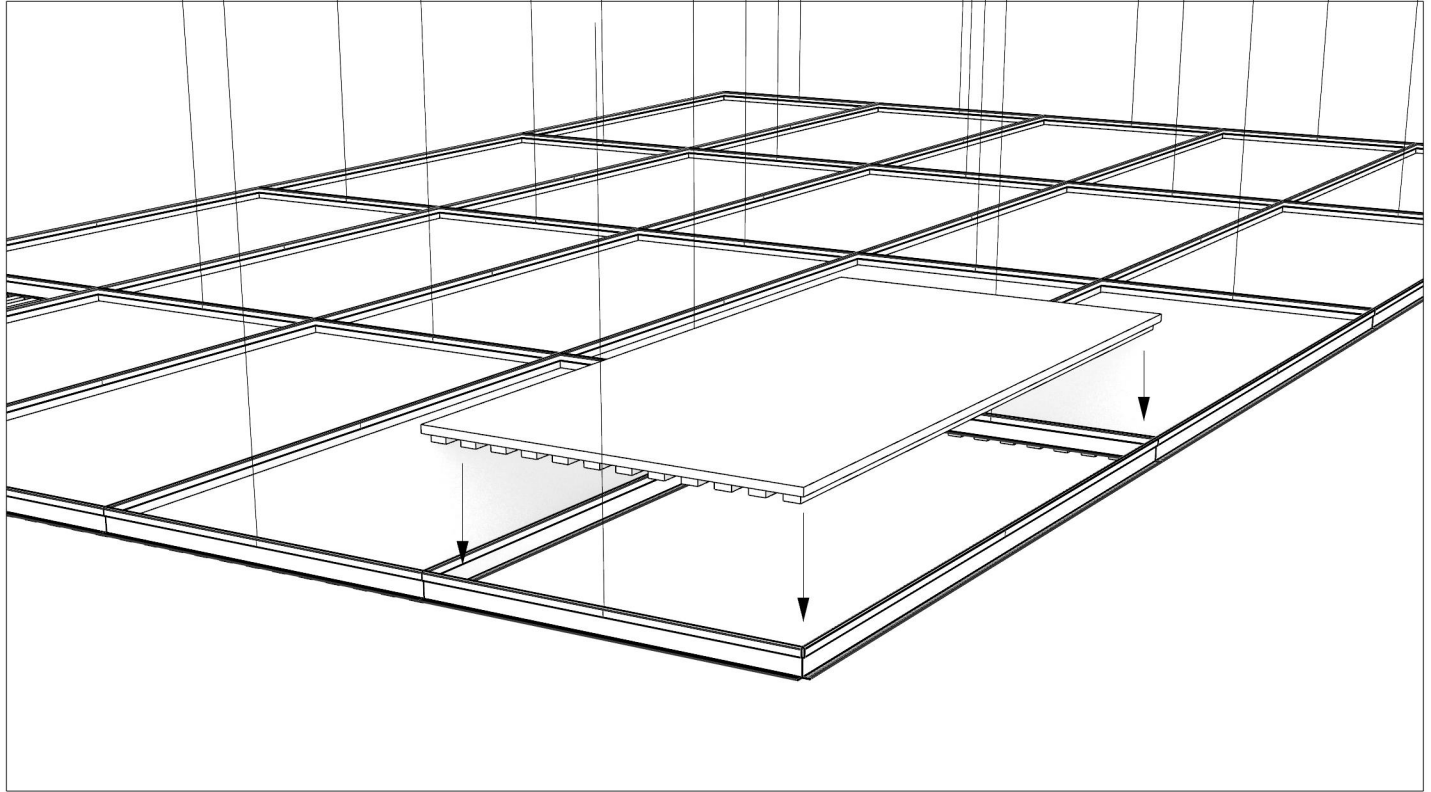

Tile Modification//Field Cutting Guide

- 1 MEASURE GRID OPENING AT DESIRED LOCATION AND ADD 3/4" TO DETERMINE FINAL TILE SIZE

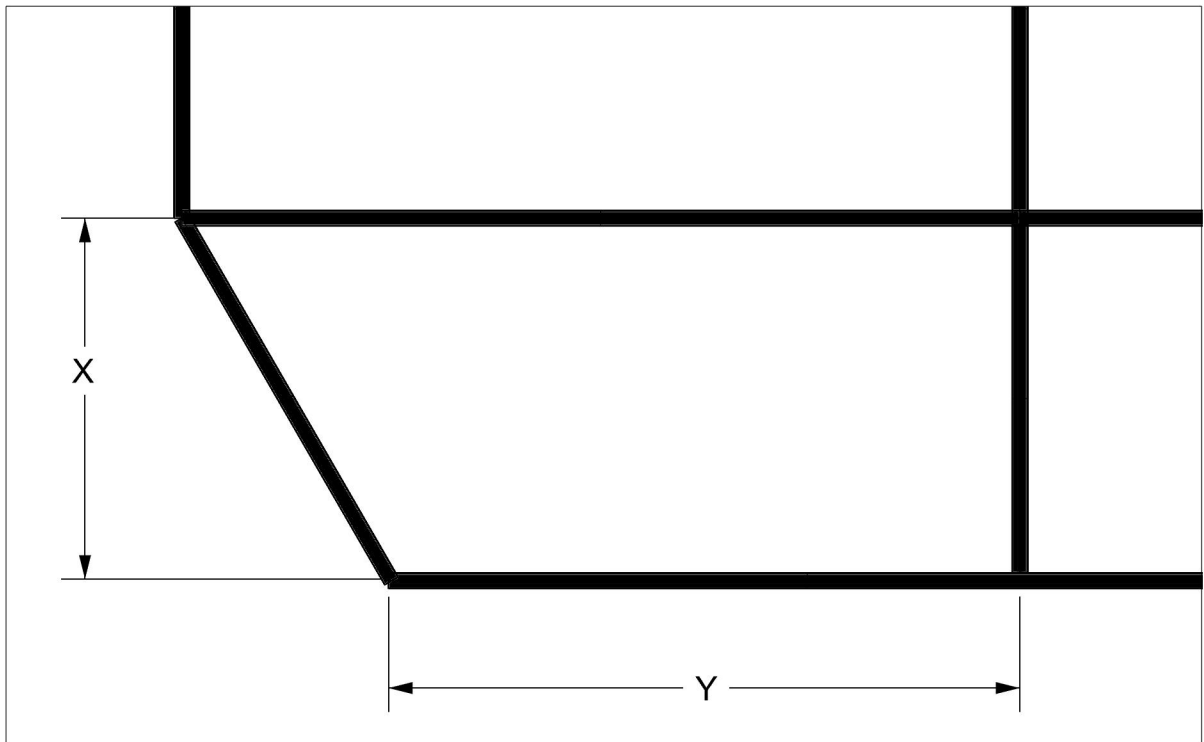

- 2 USING THE PET BACKER AS REFERENCE, MARK THE CUT LINE

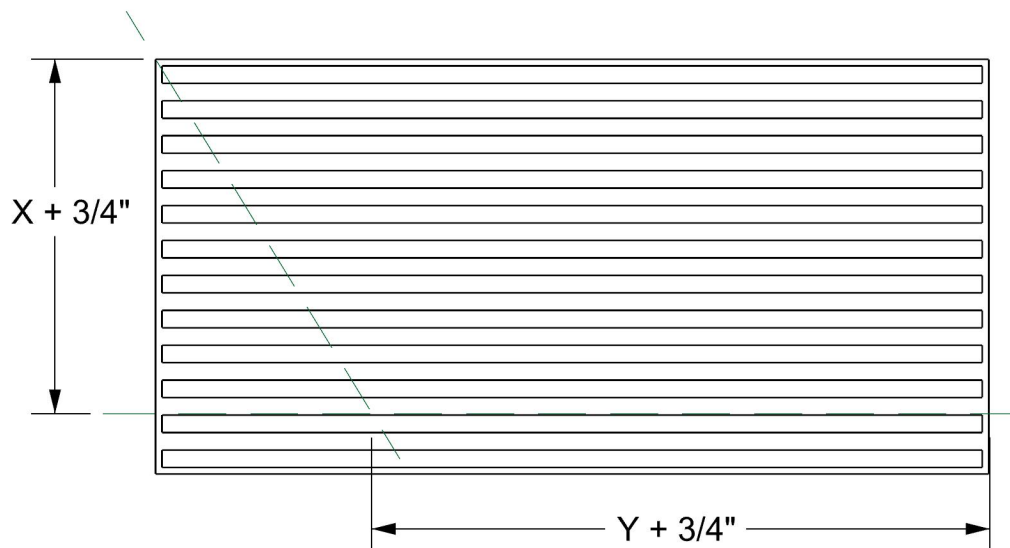

Tile Modification//Field Cutting Guide Cont.

- 3 USING A TABLE SAW, CIRCULAR SAW, OCILLATING MULTI TOOL, OR SIMILAR, CUT PANEL TO FINAL DIMENSION, ENSURING STAPLES ARE AVOIDED BY THE CUTTING TOOL. STAPLES CAN BE CAREFULLY REMOVED IF NECESSARY.

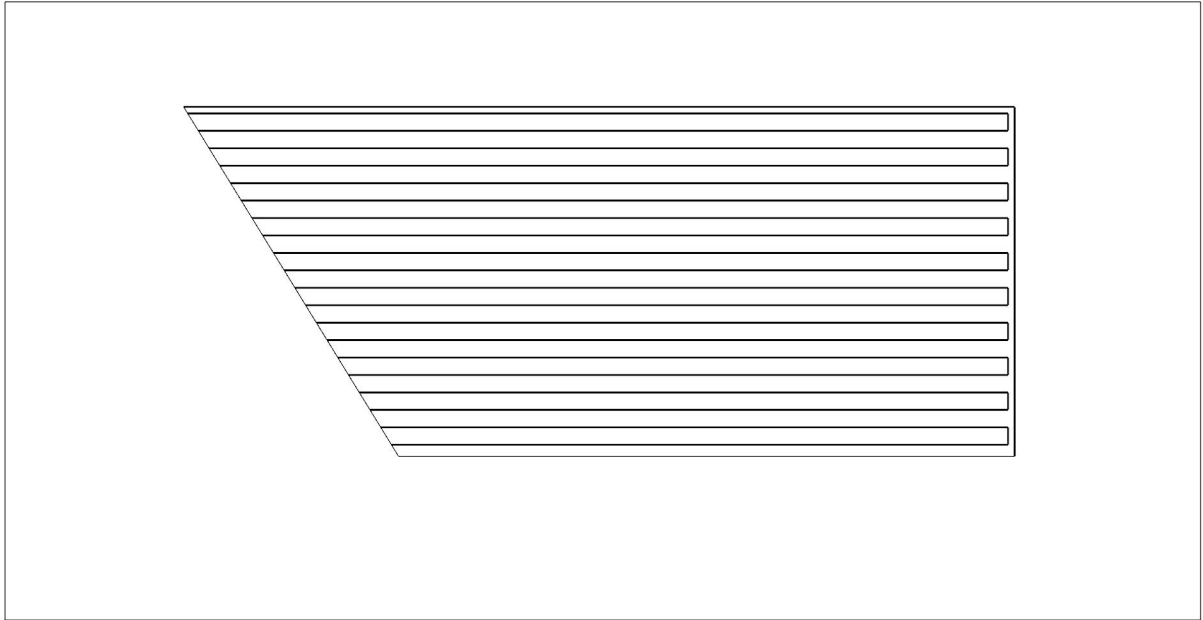

- 4 MARK SLATS $\frac{3}{8}$ " FROM THE CUT END. ALTERNATIVELY, SET TOOL FENCE SUCH THAT $\frac{3}{8}$ " OF MATERIAL WILL BE REMOVED FROM SLATS.

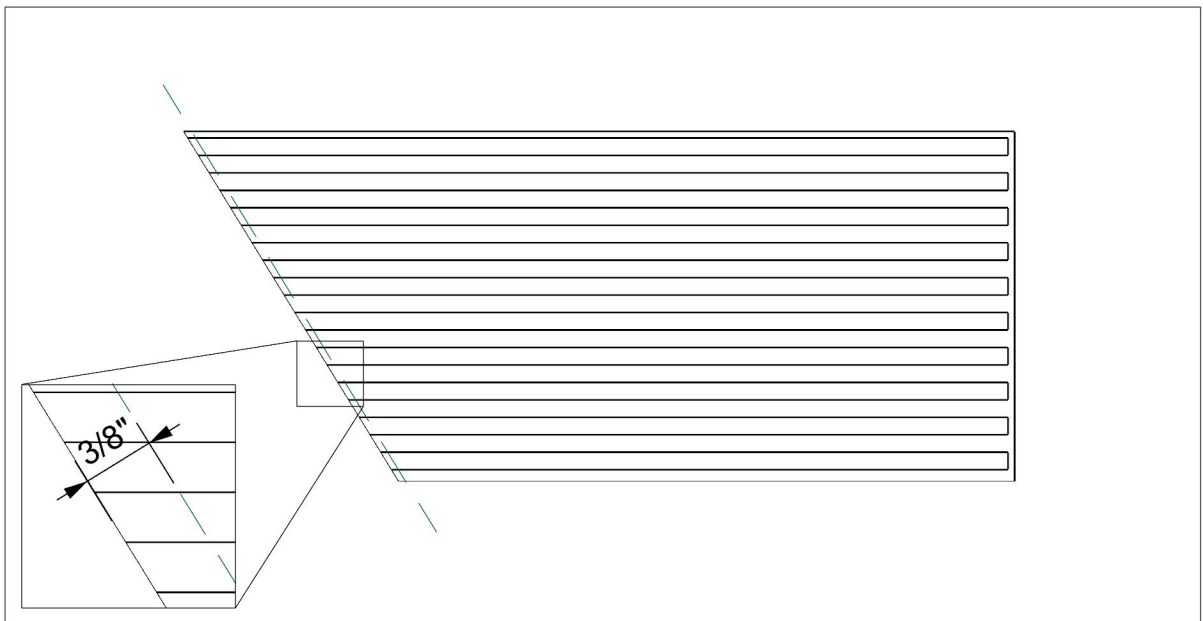

Tile Modification//Field Cutting Guide Cont.

- 5 USING A TABLE SAW, CIRCULAR SAW, OCILLATING MULTI TOOL, OR SIMILAR, TRIM SLATS TO THE LINE. AVOID CUTTING INTO PET BACKER.

