



# KEYS

PET FELT CEILING TILE

# KEYS

## PET FELT CEILING TILE

If you've ever found flat ceiling tiles uninspiring, prepare to be captivated by Keys, which adds dimension to your space. This innovative three-dimensional, multi-depth tile system is not only effortless to install within conventional grid systems but is deliberately engineered to defy convention and ignite your creative spark.

- Pre-Engineered systems available for quick delivery
- Available in a wide variety of colors
- 60% Post-Consumer Recycled Content
- NRC Rating of 0.70

## SPECS

Material Composition: 60% Post-Consumer Recycled PET Felt

Size: Nominal 2' x 2'

Height: 1", 2", 3"

Installation Method: Lay-In

NRC Rating: 0.70

Fire Rating: Class A Fire Rated per ASTM E84

VOC Emissions: Passes CDPH Standard v1.2



# EXPRESSIONS

## 2x2 Keys Height

Mix and match different height expressions to create a textured ceiling unique to your project.

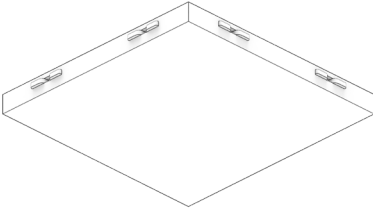

1 inch

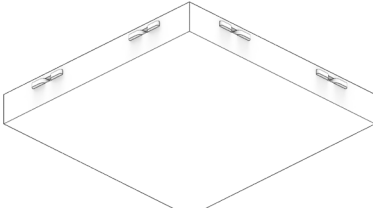

2 inch

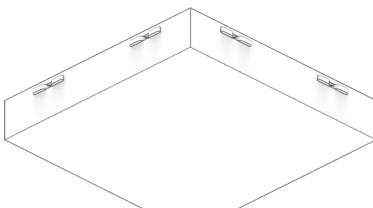

3 inch



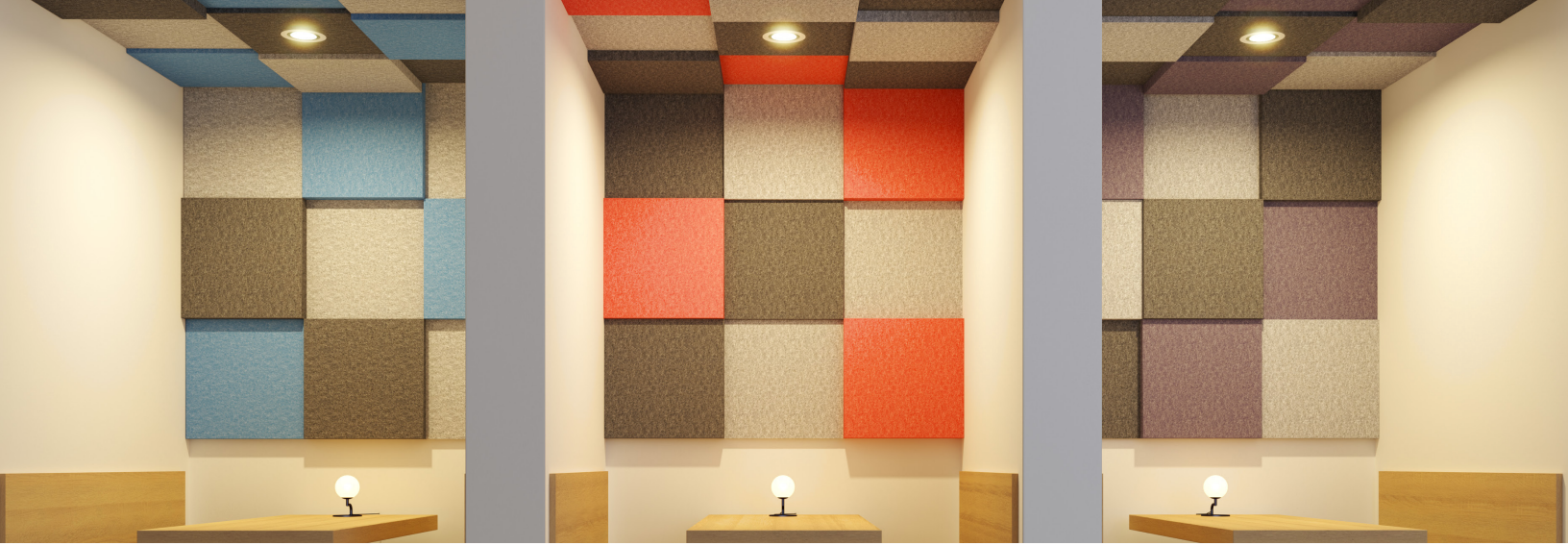

## COLORS

Decorative and tackable, available in a variety of colors or printed with custom graphics to blend into any decor.



White



Silver



Gray



Black



Beige



Tan



Brown



Orange



Lime



Blue



Purple

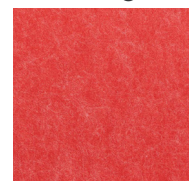

Red

## PERFORMANCE

Material Logiq PET Felt is non-allergenic, non-toxic, fungal-resistant, and do not contain chemical irritants or formaldehyde. Acoustic panel material: 100% polyester (60% PET-recycled fiber, 40% PET-virgin fiber). Our PET Felt passes the CDPH V1.2 test standard for low VOC emissions and can contribute to LEED V4.1 EQ Credit: Low-Emitting Materials.

