



# BLAFFE

PET FELT BAFFLE

# BLAFFE

## PET FELT BAFFLE

Waves, slabs, or contours? The choice is yours, but one thing is certain: your space will appear as aesthetically pleasing as it sounds. Traditional PET baffle systems need not adhere to conventional aesthetics, so let's embrace creativity.

- Pre-Engineered systems available for quick delivery
- Available in a wide variety of colors
- 60% Post-Consumer Recycled Content
- NRC Rating up to 1.05

## SPECS

Material Composition: 60% Post-Consumer Recycled PET Felt

Module Size: 4' x 4', 4' x 8'

Fins per Module: 6

Installation Method: Threaded Rod, Hanging Wire, Direct to T-Grid

NRC Rating: Up to 1.05

Fire Rating: Class A Fire Rated per ASTM E84

VOC Emissions: Passes CDPH Standard v1.2



# EXPRESSIONS

## 4x4 Blaffe PET Felt Baffle

Each Blaffe expression is made up of fins that can be rotated at installation to create variability in form and texture.

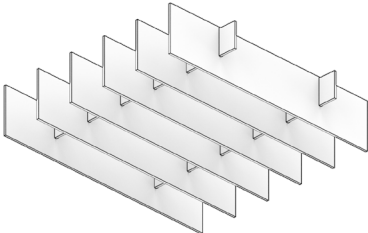

Flat

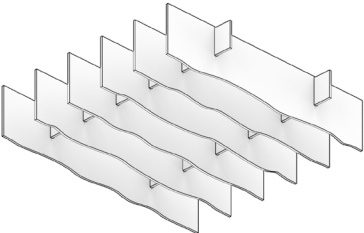

Jitter

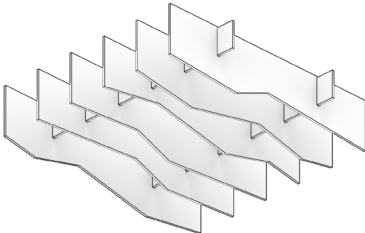

Peaks

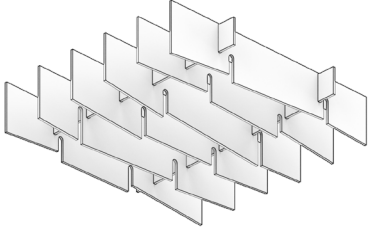

Skyline

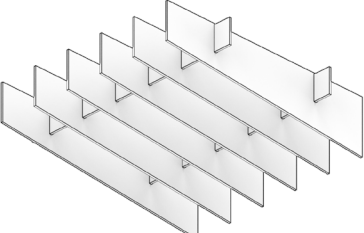

Slant

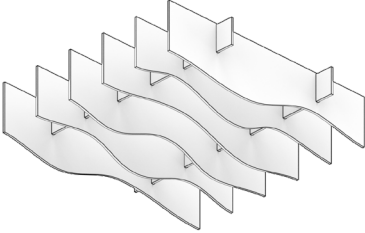

Wave

# EXPRESSIONS

## 4x8 Blaffe PET Felt Baffle

Each Blaffe expression is made up of fins that can be rotated at installation to create variability in form and texture.

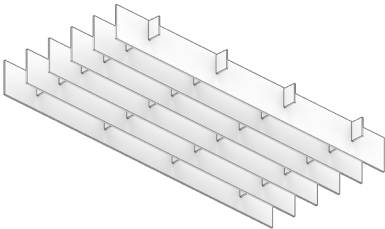

Flat

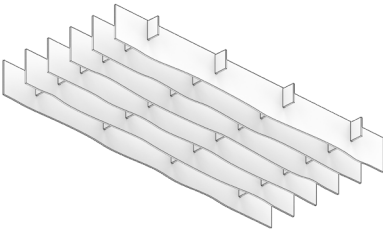

Jitter

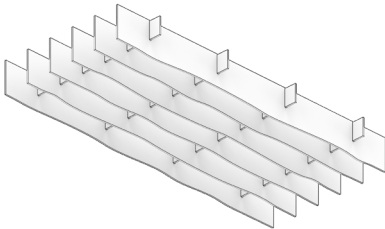

Peak

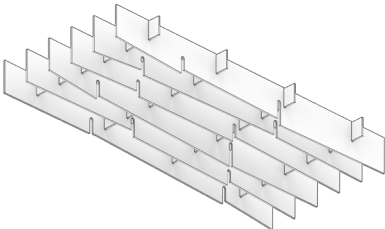

Skyline

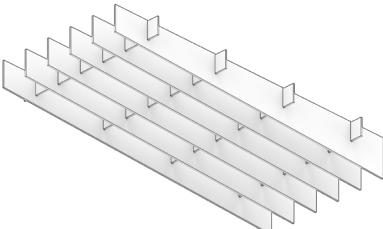

Slant

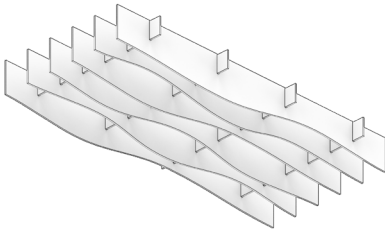

Wave



# COLORS

Decorative and tackable, available in a variety of colors or printed with custom graphics to blend into any decor.



# PERFORMANCE

Material Logiq PET Felt is non-allergenic, non-toxic, fungal-resistant, and do not contain chemical irritants or formaldehyde. Acoustic panel material: 100% polyester (60% PET-recycled fiber, 40% PET-virgin fiber). Our PET Felt passes the CDPH V1.2 test standard for low VOC emissions and can contribute to LEED V4.1 EQ Credit: Low-Emitting Materials.

